

WPC-763

Rugged A4 Size Intel Core Duo Fanless Engine Box



- True Fanless Anti-dust solution
- Socket 479 Intel® Core™ Duo /Solo processors
- Low-power platform
- VGA / LAN/CF / Audio / USB interfaces
- GPIO for data collection and device control
- HDD Anti-vibration mechanism



System

CPU	mPGA479M socket, Supports Intel® Core™ Duo /Solo processors up to 2.0 GHz (31W) standard: Core Duo T2500 2.0G Celeron M 1.86G
Chipset	Intel® 945GM chipset + ICH7M
BIOS	4Mb AMI Flash BIOS
VGA	Intel® 945GM integrated VGA (GMA950)
Audio	Realtek ALC655 AC97 Audio Codec, 2+2 watts power amplifier
LAN	1 x Realtek RTL8111B Gigabit Ethernet
Memory	Two DDR2 SODIMM socket supports up to 2GB
I/O	ICH7M
Serial ATA	Port x 1 with 150 MB/s transfer rate x 1
GPIO	4-bit input, 4-bit output (5V)
WDT	1~255 minutes, software programmable

External I/O

DVI	DVI-I digital video connector x 1
VGA	(Converted from DVI-I connector via cable) x1
USB	USB 2.0 x 4
COM	DB-9 x 6 (RS-232 x 5, RS-232/422/485 x 1)
LAN	RJ-45 x 1 (Gigabit Ethernet)
KB/Mouse	PS/2 Keyboard & Mouse x 1
Audio	Line-in, Line-out, and Mic-in audio jacks
LPT	DB-25 x 1
Power	DC-In connector x 1
GPIO	5 x 2 screw-type external terminal
Switch	ATX power switch & RESET switch
Indicator	Power and HDD indicator (Front LED color: Power: Green / Orange: HDD accessing)

Storage

HDD	2.5" SATA HDD drive bay x 1 (with anti-vibration mechanism)
CF	1 x bootable Compact Flash slot for CF type I/II storages

Expansion

Mini-PCI	1 x 32-bit Mini-PCI socket
CF	Bootable Compact Flash slot for CF type I/II storages x 1

Mechanical & Environmental

Power Input	DC12V~28V
Power Adaptor	AC90 ~ 264V / 47 ~ 63 Hz/ DC input 12V
Operating Temperature	0~40°C
Storage Temperature	-20~80°C
Relative Humidity	10%~90%, non-condensing
Dimension	292mm (L) x 190mm (W) x 60.4 mm (H)
Weight	3.1 kg
Regulations	FCC-A, CE, VCCI, UL/cUL

Fully-integrated I/O

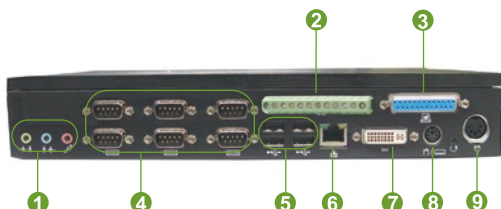

- | | |
|-----------|--------------------|
| 1 Audio | 6 LAN |
| 2 GPIO | 7 DVI |
| 3 LPT | 8 Keyboard / Mouse |
| 4 COM | 9 Reset Switch |
| 5 USB 2.0 | 10 Power |

WPC-763

Rugged A4 Size Intel Core Duo Fanless Engine Box

Drawing

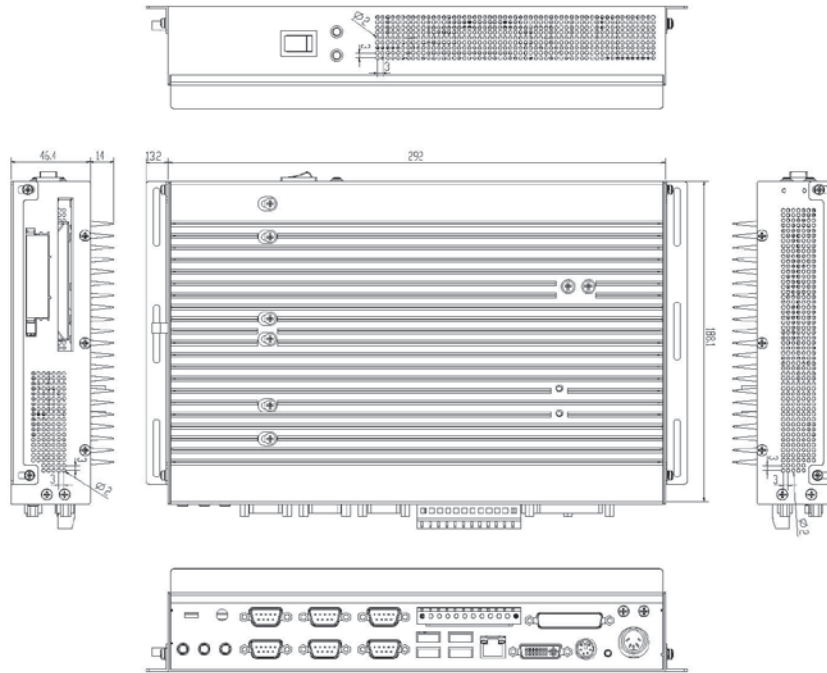

Option Features

- Wireless LAN x1 (Mini-PCI socket)
- TV w/ Capture (USB slot)

TV w/ Capture



USB

Wireless LAN

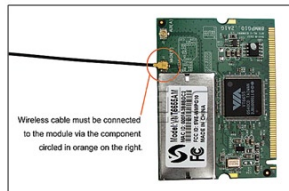

Mini-PCI



Application:

Auto-Power On

After power shut down, 763 can be auto power on when the power comes back.

- A unique design by specific hardware circuit, 12-28V DC Component and firmware control.
- Some application power on/off by daily basic, the long-term reliability must be considered seriously.



Key Features



VGA/DVI dual cable



DC-DC 12-28V Cable

Ordering information

1. WPC-763-CoreDuo2.0G-512-160
2. WPC-763-CM1.86-512-160



Wincomm Corporation

3F, NO. 14, Prosperity Road II, Science-Based Industrial Park,
Hsinchu, Taiwan 30078, R.O.C

Tel : +886 3 578 0000 Fax: +886 3 578 0295

Web: www.wincomm.com.tw

Contact: sales_support@wincomm.com.tw